

DWG NO.		484040		REV		1	
REVISIONS							
ZONE	REV	DESCRIPTION		DFTR	CHKR	APPD	
---	1	RELEASE FOR TOOLING PER ECN C027771		J. CHANG 08/04/03	F. LIANG 08/05/03	C.H. KUO 08/05/03	

NOTES: UNLESS OTHERWISE SPECIFIED

1. PLASTIC COMPONENT FABRICATOR SHALL ADHERE TO MOTOROLA BCS SPEC 080698-001.
2. THIS DRAWING IS INCOMPLETE WITHOUT PRO/ENGINEER CAD DATA BASE, FILE 484040.PRT, LATEST REVISION, WHICH SHALL BE PROVIDED TO THE MANUFACTURER. IN THE EVENT OF CONFLICT, THIS DRAWING SHALL BE THE CONTROLLING DOCUMENT.
3. MATERIAL: CYCOLOY PLASTIC (PC/ABS BLEND), USE GE C6600, GE C6200, LG GP-5006AF, OR BAYER BAYBLEND FR110, FR2010. COLOR SHALL BE PMS BLACK OR GE COLOR #BK1A380 OR BAYER COLOR #901510 OR EQUIVALENT.
4. OUTSIDE SURFACES (EXCEPT AS INDICATED) SHALL BE TEXTURED PER MOLD-TECH MT-11010.
5. SURFACE SHALL BE FREE OF TEXTURE AND SHALL BE POLISHED PER SPI B3.
6. DIMENSIONS ARE METRIC (MILLIMETERS). INTERPRET PER ANSI Y14.5M.
7. INTERNAL RADIUS: MINIMUM 0.3MM, MAXIMUM 0.5MM, UNLESS OTHERWISE SPECIFIED.
8. IDENTIFY PER MOTOROLA BCS SPEC 407545-001, TYPE XV, WITH 484040, AND CAVITY NUMBER, AND DATE CODE, AND DASH NUMBER, AND MATERIAL, APPROXIMATELY WHERE SHOWN.
9. FOR NEXT ASSEMBLY AND USED ON APPLICATION, REFER TO LATEST APPROPRIATE MOTOROLA BCS DATABASE.
10. LINER TOLERANCE SHALL BE:  
XX ±.5  
XX.X ± .2  
XX.XX ± .11

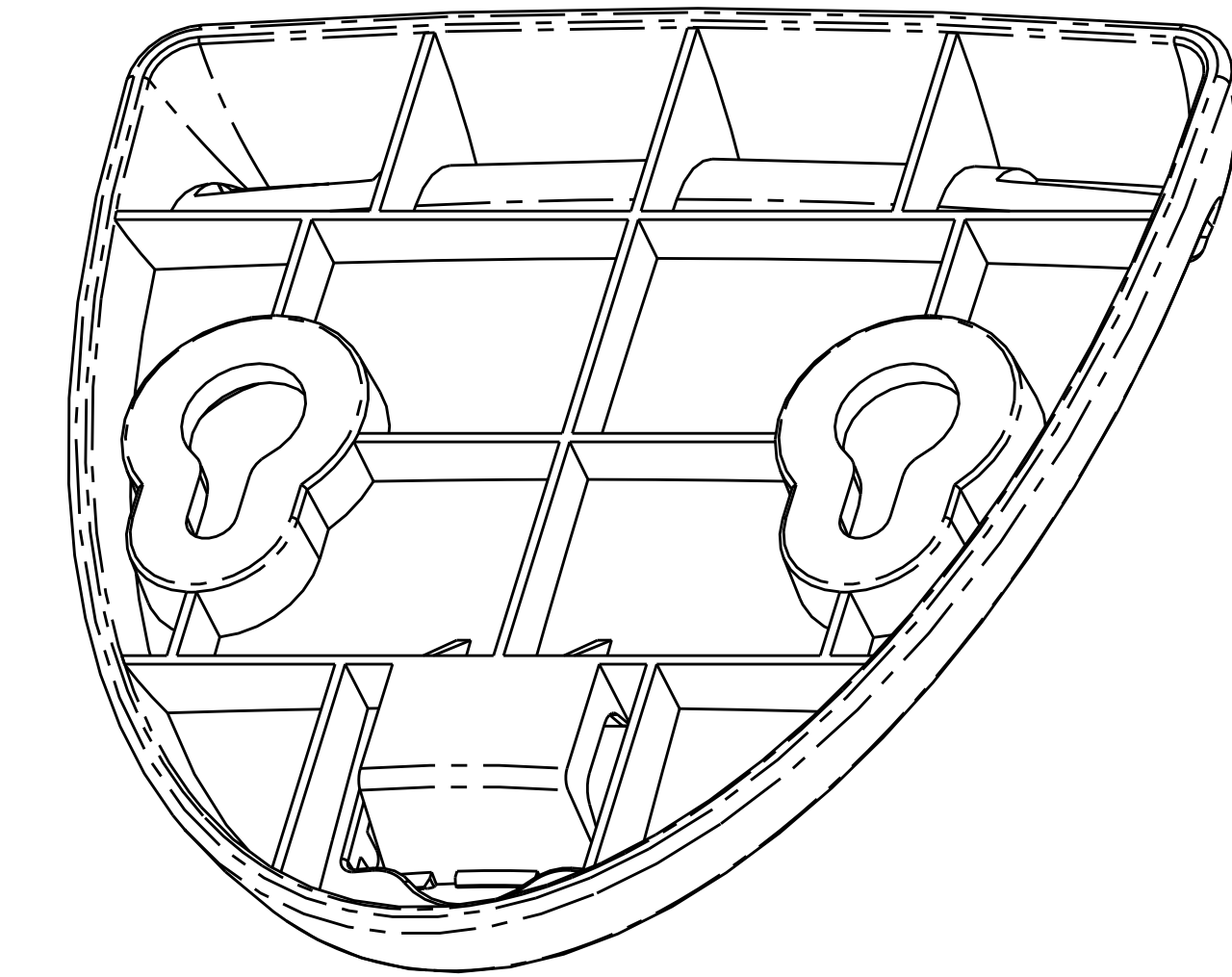
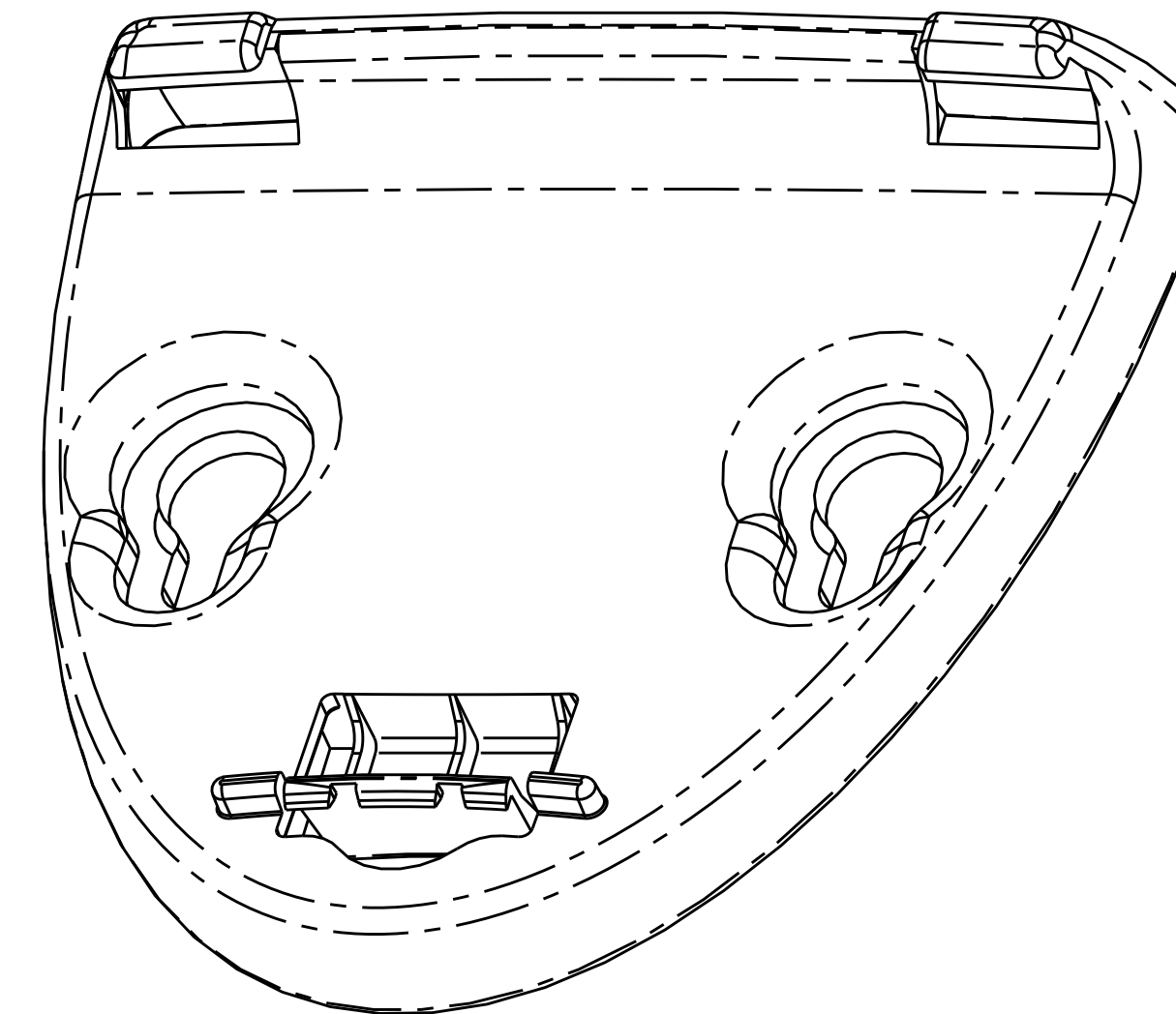

**-001 SHOWN**  
VIEWS ARE FOR REFERENCE ONLY  
SCALE NONE

**MOTOROLA INTERNAL USE (LEVEL 2)**

ALL INFORMATION CONTAINED IN THIS DOCUMENT IS CONFIDENTIAL AND PROPRIETARY TO MOTOROLA, INC. BROADBAND COMMUNICATIONS SECTOR. NO LICENSE EXPRESSED OR IMPLIED, UNDER ANY PATENT, COPYRIGHT OR TRADE SECRET RIGHT IS GRANTED OR IMPLIED BY THE CONVEYANCE OF THIS DOCUMENT. NO PART OF THIS DOCUMENT MAY BE REPRODUCED, TRANSMITTED, TRANSCRIBED, STORED IN A RETRIEVAL SYSTEM, TRANSLATED INTO ANY LANGUAGE OR COMPUTER LANGUAGE, IN ANY FORM BY ANY MEANS ELECTRONIC, MECHANICAL, MAGNETIC, OPTICAL, CHEMICAL, OR OTHERWISE WITHOUT THE PRIOR WRITTEN PERMISSION OF MOTOROLA, INC. BROADBAND COMMUNICATIONS SECTOR. (SEE DOCUMENT SECURITY STANDARD, 320190-000 FOR DETAILS)

MOTOROLA, THE STYLIZED "M" LOGO AND ALL OTHER TRADEMARKS INDICATED AS SUCH HEREIN ARE TRADEMARKS OF MOTOROLA, INC. REGISTERED U.S. PATENT TRADEMARK OFFICE. ALL OTHER PRODUCT OR SERVICE NAMES ARE THE PROPERTY OF THEIR RESPECTIVE OWNERS.

COPYRIGHT 2000-2002 MOTOROLA, INC. ALL RIGHTS RESERVED.

DRAWING CREATED USING PRO/ENGINEER RELEASE 2001  
PRO/PDM PRODUCT DATA BASE: PC\_LINX, FILE: 484040.drw, REVISION: 1.0

**DRAWING IS IN METRIC**  
SEE SEPARATE PARTS LIST: XXXXXX-(APPROPRIATE DASH NO.)

THIRD ANGLE PROJECTION		-003	-002	-001	QTY REQD	PART NO.	DESCRIPTION	MATERIAL / MANUFACTURER	ITEM NO.
<b>PARTS LIST</b>									
METRIC		UNIFIED		PRODUCT NO.		DATE			
UNLESS OTHERWISE SPECIFIED		UNLESS OTHERWISE SPECIFIED		SB5100		08/04/03			
DIMENSIONS ARE IN MILLIMETERS AND APPLY AFTER SURFACE TREATMENT		DIMENSIONS ARE IN INCHES AND APPLY AFTER SURFACE TREATMENT		DSGN		JOHNNY CHANG			
TOLERANCES (MILLIMETERS)		TOLERANCES (INCHES)		CHKR		TITLE			
LINEAR	ANGULAR	LINEAR	ANGULAR	ELEC ENGR		<b>HLDR.MTG.WALL SB5100</b>			
XX ± .2	EXCL OF SHEET METAL FLANGES ± 0° 30'	.X ± .1	EXCL OF SHEET METAL FLANGES ± 0° 30'	MECH ENGR					
X.X ± 0.5		.XX ± .02		PE/CTM					
X.XX ± 0.25		.XXX ± .010		MFG ENG		MFG CTM		O.A./CTM	
HOLE DIA TOLERANCES		HOLE DIA TOLERANCES		MFG CTM		SIZE		PROJECT	
0.34 - 6.35	+0.13 -0.03	0.135 - .250	+0.005 - .001	D SURFBOARD		484040		DRAWING NO	
6.38 - 12.70	+0.15 -0.03	.251 - .500	+0.006 - .001	CONFIG		REV		1	
12.73 - 25.4	+0.25 -0.03	.501 - 1.000	+0.010 - .001	REGULATORY		SCALE: 1/1		SHEET 1 OF 2	

10

REVISIONS			DFTR	CHKR	APPD
ZONE	REV	DESCRIPTION			
		SEE SHEET 1			

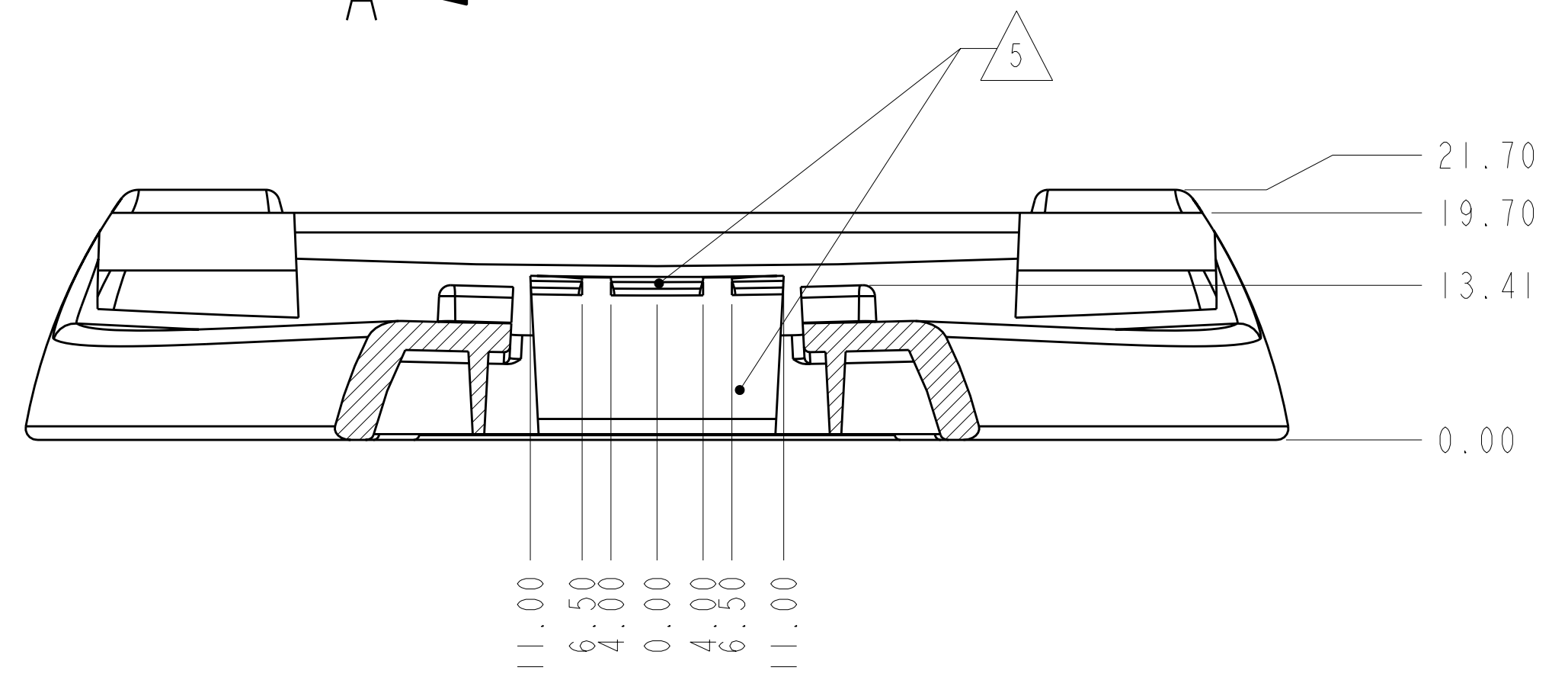
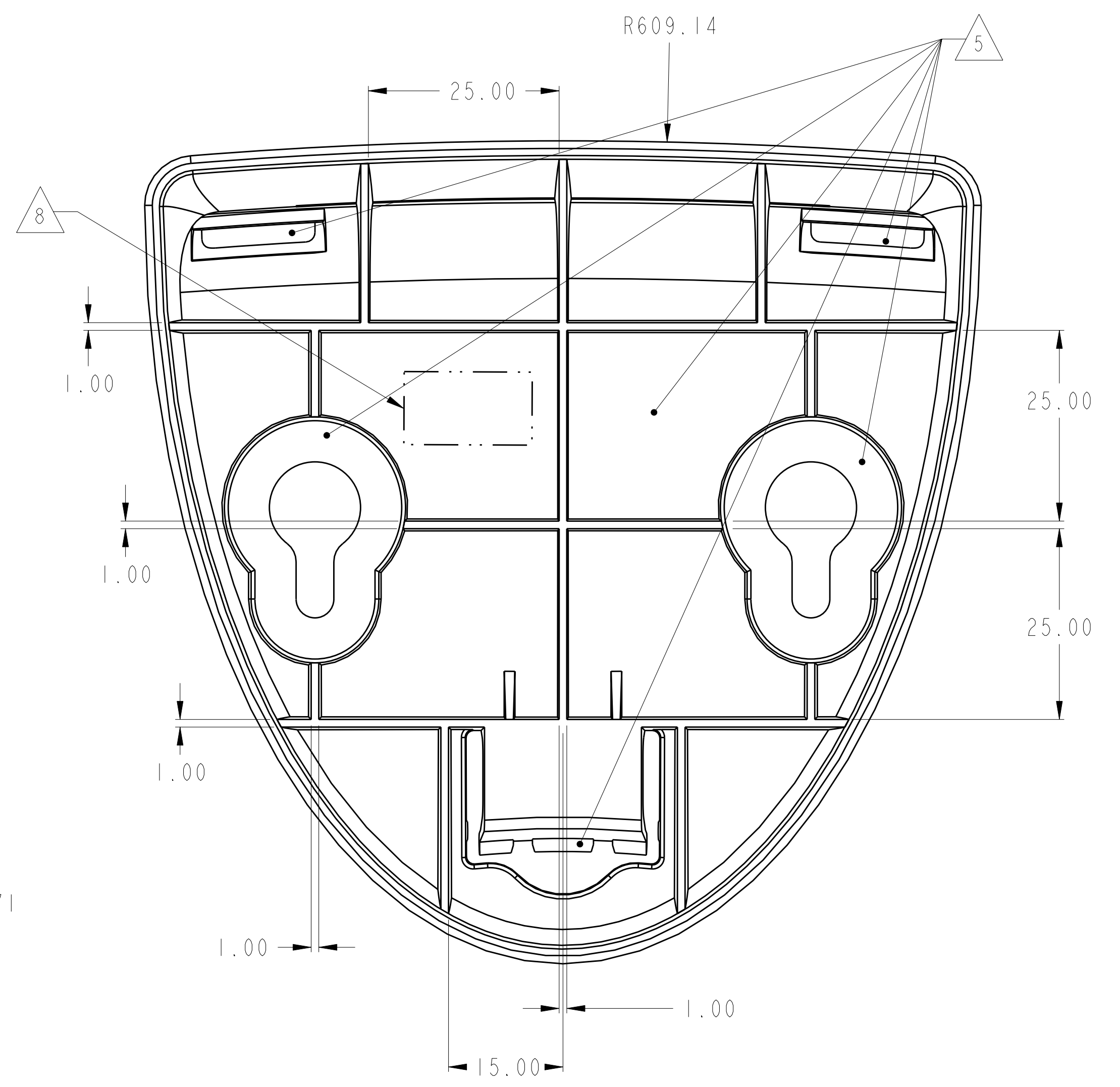
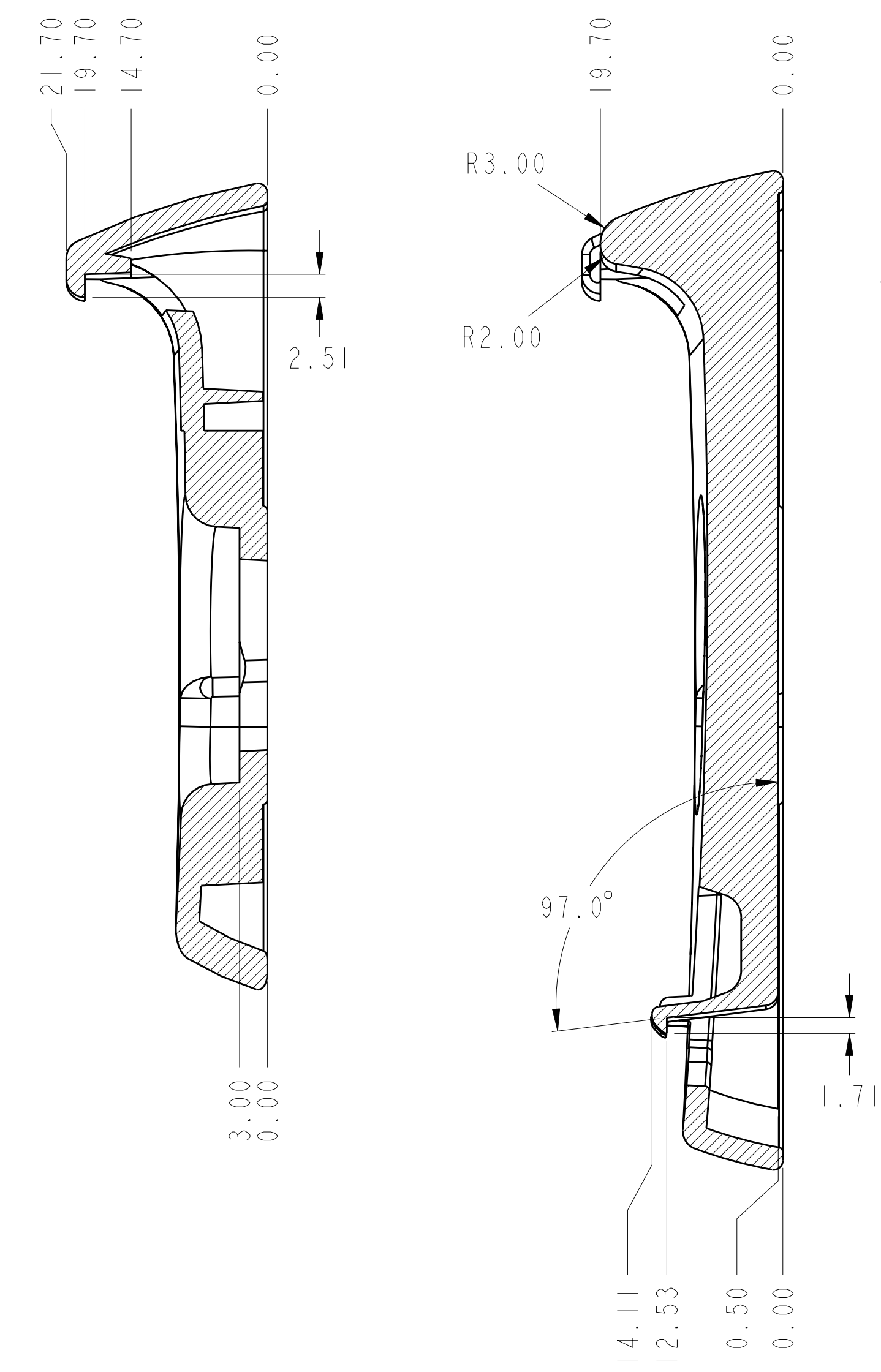
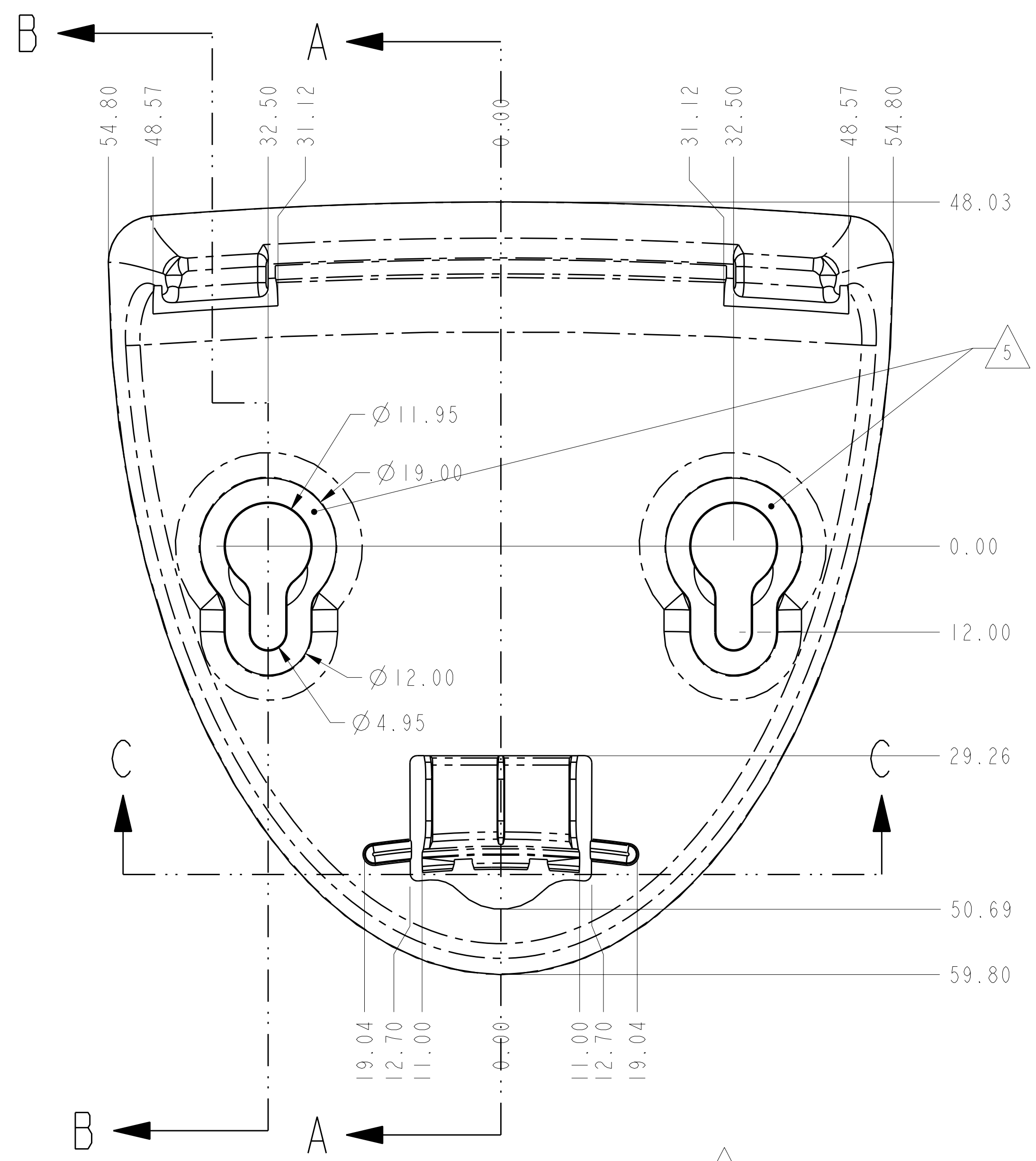

SECTION B-B SECTION A-A

-001 SHOWN

SECTION C-C